



# RACCORDI A COMPRESSIONE

COMPRESSION FITTINGS

Compression fittings are so defined because the tube closing on the fitting is made by a cutting compression ogive which holds on the tube.

Compression fittings are suitable for the assembly of rigid tubes (copper, brass,...); for possible use of "plastic" tubes a special stiffener (cod. IR100) is necessary to be inserted in the tube until the suitable support.

All fittings belonging to this category have been planned according to DIN rules which control the product.

In our range of products there are two series of compressed fittings which differ from each other for the following features: "Series 1" is nickel plated equipped with ogive with simple section; every threading is provided of thin pitch (also for the Ø higher than 8); the "series 5" is raw brass with biconical ogive and, for higher Ø than 8, the threading is metric.



<b>Standard supply</b>	Ø Tube from 4 to 15mm Thread from 1/8 to 1/2"	
<b>Material</b>	Body and nut in nickel plated brass Nbr seal (Viton upon request)	
<b>Pressure</b>	Ø 4 Max 130 bar Ø 6 Max 180 bar Ø 8 Max 150 bar Ø 10 Max 110 bar Ø 12 Max 75 bar Ø 14 Max 70 bar Ø 15 Max 70 bar	
<b>Use temperature</b>	-15°C +80°C	
<b>Thread</b>	Taper gas	Iso 7.1 Din 2999
	Parallel gas	Iso 228 classe A
	Metric	Iso R/262
<b>Use</b>	Compressed air - Water - Oil	
<b>Tube</b>	Copper - Brass - Steel - Aluminium PA6 - PA11-PA12 only with suitable support IR100	
<b>Options</b>	V (See pag. 3)	

I raccordi a compressione vengono così definiti in quanto il serraggio del tubo sul raccordo avviene mediante la compressione di un'ogiva tagliente che va ad aggrapparsi al tubo stesso.

I raccordi a compressione sono adatti negli assemblaggi di tubi rigidi (rame, ottone, ecc.); per eventuali utilizzi di tubi "plastici" è necessario utilizzare un apposito rinforzo (cod. IR100) che va inserito all'interno del tubo fino all'apposita battuta di appoggio.

Tutti i raccordi appartenenti a questa categoria sono stati progettati seguendo le norme DIN che regolamentano il prodotto.

Nella nostra gamma esistono due serie di raccordi a compressione che differiscono per le seguenti caratteristiche: la "Serie 1" è nichelata di serie e dotata di ogiva con profilo semplice; le filettature sono tutte a passo fine (anche per i Ø superiori a 8); la "Serie 5" è grezza di serie, con ogiva bicono e, per i Ø superiori a 8, la filettatura è metrica.



Ø Tubo da 4 a 15  
filetto da 1/8 a 1/2

**Disponibilità standard**

Corpo e Dado in Ottone Nichelato  
Guarnizione in Nbr (Viton su richiesta)

**Materiali**

Ø 4 Max 130 bar  
Ø 6 Max 180 bar  
Ø 8 Max 150 bar  
Ø 10 Max 110 bar  
Ø 12 Max 75 bar  
Ø 14 Max 70 bar  
Ø 15 Max 70 bar

**Pressione**

-15°C +80°C

**Temperatura di utilizzo**

Gas Coniche Iso 7.1 Din 2999  
Gas Cilindriche Iso 228 classe A  
Metriche Iso R/262

**Filettature**

Aria Compressa - Acqua - Olio

**Impiego**

Rame - Ottone - Acciaio - Alluminio  
PA6 - PA11 - PA12 solo con apposito rinforzo IR100  
V (Vedi pag. 3)

**Tubazioni**

**Opzioni**

## Raccordo diritto maschio conico Straight male adapter (taper)

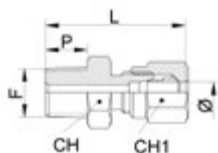

Code	Ø	F	P	L	CH	CH1	Gr
D105184NI	4	1/8	8,0	27,5	12	10	14,0
D105144NI	4	1/4	11,0	30,5	14	10	18,0
D105185NI	5	1/8	8,0	27,5	12	10	14,0
D105186NI	6	1/8	8,0	27,5	12	12	15,0
D105146NI	6	1/4	11,0	31,5	14	12	24,5
D105386NI	6	3/8	11,0	31,5	17	12	34,5
D105126NI	6	1/2	14,0	34,0	22	12	60,5
D105187NI	7	1/8	8,0	30,0	12	14	17,0
D105188NI	8	1/8	8,0	31,0	12	14	19,0
D105148NI	8	1/4	11,0	33,0	14	14	26,0
D105388NI	8	3/8	11,0	34,0	17	14	38,0
D1051410NI	10	1/4	11,0	33,0	14	17	28,5
D1053810NI	10	3/8	11,0	33,5	17	17	39,5
D1051210NI	10	1/2	14,0	36,5	22	17	64,0
D1051412NI	12	1/4	11,0	33,0	17	19	34,0
D1053812NI	12	3/8	11,0	33,5	17	19	42,0
D1051212NI	12	1/2	14,0	36,5	22	19	54,5
D1051214NI	14	1/2	14,0	40,0	22	22	72,0
D1051215NI	15	1/2	14,0	42,5	22	27	81,0

## Raccordo diritto maschio cilindrico Straight male adapter (paralle)

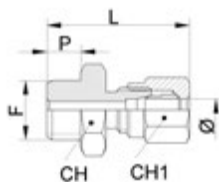

Code	Ø	F	P	L	CH	CH1	Gr
D1053184NI	4	1/8	6,0	25,5	14	10	15,0
D1053186NI	6	1/8	6,0	25,5	14	12	17,0
D1053146NI	6	1/4	8,0	28,5	17	12	23,8
D1053386NI	6	3/8	9,0	29,5	19	12	33,0
D1053188NI	8	1/8	6,0	29,0	14	14	20,0
D1053148NI	8	1/4	8,0	30,0	17	14	25,8
D1053388NI	8	3/8	9,0	31,0	19	14	36,0
D10531410NI	10	1/4	8,0	30,0	17	17	29,6
D10533810NI	10	3/8	9,0	31,5	19	17	38,8

## Raccordo diritto femmina

### Straight female adapter

Code	Ø	F	P	L	CH	CH1	Gr
D106184NI	4	1/8	8,0	27,0	14	10	17,0
D106186NI	6	1/8	8,0	28,0	14	12	21,0
D106146NI	6	1/4	10,0	31,0	17	12	23,5
D106188NI	8	1/8	8,0	29,5	14	14	23,0
D106148NI	8	1/4	10,0	32,5	17	14	23,0
D106388NI	8	3/8	11,0	34,5	20	14	22,5
D1061410NI	10	1/4	10,0	32,0	17	17	34,5
D1063810NI	10	3/8	11,0	36,5	20	19	40,0
D1061210NI	10	1/2	14,0	35,0	24	17	37,0

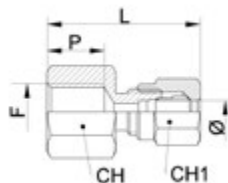

## Raccordo diritto intermedio

### Straight connector

Code	Ø	Ø1	L	CH	CH1	CH2	Gr
DD1254NI	4	4	35,0	10	10	-	16,0
DD1256NI	6	6	37,0	12	12	-	23,0
DD1258NI	8	8	40,0	14	14	-	29,0
DD12510NI	10	10	42,0	17	17	-	45,5
DD12512NI	12	12	42,0	19	19	-	54,0
DD12514NI	14	14	47,0	22	22	-	81,0
DD12515NI	15	15	49,0	24	24	-	101,0
DD1256486NI	6	8	38,5	14	12	14	28,0

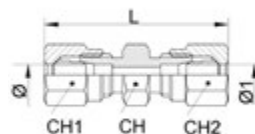

## Raccordo a L maschio conico Elbow male adapter (taper)

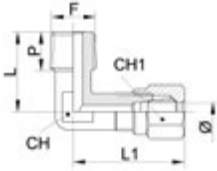

Code	Ø	F	P	L	L1	CH	CH1	Gr
L102184NI	4	1/8	8,0	18,0	24,0	9	10	15,6
L102144NI	4	1/4	11,0	20,0	23,5	10	10	24,6
L102186NI	6	1/8	8,5	17,0	24,5	9	13	22,4
L102146NI	6	1/4	11,0	20,0	24,0	10	12	28,4
L102188NI	8	1/8	8,0	18,0	25,5	10	14	24,6
L102148NI	8	1/4	11,0	21,0	29,0	10	14	28,4
L102388NI	8	3/8	11,0	26,5	32,5	14	14	46,4
L102128NI	8	1/2	14,0	30,0	34,0	17	14	65,0
L1021810NI	10	1/8	8,0	21,5	25,0	10	17	32,2
L1021410NI	10	1/4	11,0	25,0	29,5	14	17	46,8
L1023810NI	10	3/8	11,0	26,5	32,0	14	17	50,2
L1021210NI	10	1/2	14,0	30,0	33,0	17	17	67,6
L1021412NI	12	1/4	11,0	26,5	33,0	14	19	49,0
L1023812NI	12	3/8	11,0	26,5	33,0	14	19	54,2
L1021212NI	12	1/2	14,0	30,0	33,0	17	19	75,4
L1023814NI	14	3/8	11,0	26,5	39,0	17	22	70,6
L1021214NI	14	1/2	14,0	30,0	39,0	17	22	87,2
L1021215NI	15	1/2	14,0	30,0	37,0	17	24	86,8

## Raccordo a L femmina Elbow female adapter

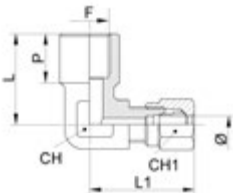

Code	Ø	F	P	L	L1	CH	CH1	Gr
L109184NI	4	1/8	8,0	20,5	25,0	10	10	25,4
L109186NI	6	1/8	8,0	20,5	25,0	10	12	28,6
L109146NI	6	1/4	10,0	23,5	25,0	11	12	30,4
L109188NI	8	1/8	8,0	21,5	27,0	10	14	28,4
L109148NI	8	1/4	10,0	23,5	27,0	11	14	33,0
L1091410NI	10	1/4	10,0	27,5	31,0	14	17	50,8
L1091210NI	10	1/2	12,0	34,0	51,5	22	17	124,8

## Raccordo a L intermedio Elbow connector

Code	Ø	L	CH	CH1	Gr
L1224NI	4	27,0	9	10	19,0
L1226NI	6	24,5	9	13	31,5
L1228NI	8	28,5	10	14	35,5
L12210NI	10	32,0	14	17	57,0
L12212NI	12	35,0	13	19	69,0
L12214NI	14	39,0	17	22	99,5

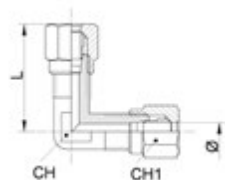

## Raccordo a T intermedio Tee connector

Code	Ø	L	CH	CH1	Gr
TT1214NI	4	42,0	9	10	23,5
TT1216NI	6	46,0	9	12	33,0
TT1218NI	8	54,0	12	14	50,0
TT12110NI	10	60,0	12	17	68,0
TT12112NI	12	68,0	13	19	96,0
TT12115NI	15	74,5	17	24	157,0

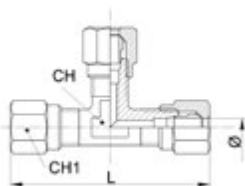

## Raccordo a T maschio centrale conico Tee male adapter - centre leg (taper)



Code	Ø	F	P	L	L1	CH	CH1	Gr
TC100184NI	4	1/8	8,0	16,0	21,5	9	10	22,0
TC100186NI	6	1/8	8,0	16,0	23,0	9	12	27,0
TC100146NI	6	1/4	11,0	20,0	25,0	10	12	35,0
TC100188NI	8	1/8	8,0	20,5	26,5	12	14	37,0
TC100148NI	8	1/4	11,0	20,5	27,0	10	14	43,0
TC100388NI	8	3/8	11,0	24,0	31,0	13	14	59,5
TC1001410NI	10	1/4	11,0	23,0	30,0	12	17	58,0
TC1003810NI	10	3/8	11,0	26,0	34,0	13	17	70,5
TC1001210NI	10	1/2	14,0	28,0	36,0	17	17	104,2
TC1001412NI	12	1/4	11,0	26,0	34,0	13	19	75,3
TC1003812NI	12	3/8	11,0	26,0	34,0	13	19	81,0
TC1001212NI	12	1/2	14,0	28,0	36,0	17	19	80,5
TC1001215NI	15	1/2	14,0	28,0	38,0	17	24	130,8

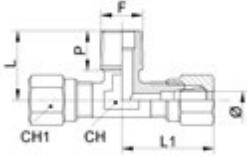

## Raccordo a T maschio laterale conico Tee male adapter - offset leg (taper)



Code	Ø	F	P	L	L1	CH	CH1	Gr
TL101184NI	4	1/8	8,0	38,5	22,5	9,0	10,0	22,0
TL101186NI	6	1/8	8,0	39,5	23,5	9,0	12,0	27,0
TL101146NI	6	1/4	11,0	45,0	25,0	10,0	12,0	35,0
TL101188NI	8	1/8	8,0	46,5	26,5	12,0	14,0	37,0
TL101148NI	8	1/4	11,0	47,5	28,0	10,0	14,0	43,0
TL101388NI	8	3/8	11,0	58,5	34,5	13,0	14,0	59,5
TL1011410NI	10	1/4	11,0	53,0	30,0	12,0	17,0	58,0
TL1013810NI	10	3/8	11,0	60,0	34,0	13,0	17,0	70,5
TL1011210NI	10	1/2	14,0	64,0	36,0	17,0	17,0	104,2
TL1011412NI	12	1/4	11,0	60,0	34,0	13,0	19,0	76,6
TL1013812NI	12	3/8	11,0	60,0	34,0	13,0	19,0	81,0
TL1011212NI	12	1/2	14,0	64,0	36,0	17,0	19,0	80,5

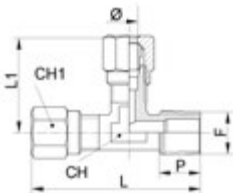



## Dado di bloccaggio Locking nut

Code	Ø	F	L	CH	Gr
G1304NI	4	M8x1	11,0	10,0	4,0
G1305NI	5	M8x1	11,0	10,0	4,0
G1306NI	6	M10x1	12,0	12,0	5,5
G1307NI	7	M12x1	13,0	14,0	7,5
G1308NI	8	M12x1	13,0	14,0	7,5
G13010NI	10	M14x1	13,0	17,0	12,0
G13012NI	12	M16x1	13,0	19,0	14,0
G13014NI	14	M18x1	14,0	22,0	21,5
G13015NI	15	M20x1	15,0	24,0	26,0

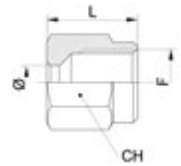

## Ogiva Ogive

Code	Ø	L	Gr
OG1314GR	4	6,0	0,5
OG1315GR	5	6,0	0,5
OG1316GR	6	7,5	1,0
OG1317GR	7	7,0	0,9
OG1318GR	8	7,0	1,0
OG1310GR	10	7,0	1,2
OG13112GR	12	7,0	1,5
OG13114GR	14	7,0	1,8
OG13115GR	15	8,0	2,8

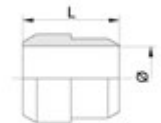

## Tappo ogiva Ogival plug



Code	Ø	L	Gr
OG1356GR	6	10,0	3,4
OG13514GR	14	9,5	14,2
OG13515GR	15	10,5	18,8
OG13516GR	16	10,5	21,4

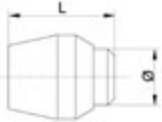

## Bussola di rinforzo Internal support bush



Code	F	F1	C	L	Gr
IR1002GR	2	1,25	3,5	8	0,5
IR10025GR	2,5	1,7	3,5	12,0	0,4
IR1004GR	4	3,3	5	12,0	0,4
IR1006GR	6	5,0	7	15,0	1,0
IR1008GR	8	7,0	9	15,0	1,4
IR1009GR	9	8,0	10	15,0	1,6
IR10010GR	10	9,0	11	15,0	1,8
IR10011GR	11	10,0	12	17,0	2,4
IR10012GR	12	11,0	13	17,0	2,6
IR100125GR	12,5	11,5	14	17,0	2,8
IR10014GR	14	13,0	15	17,0	2,8
IR10015GR	15	14,0	16	17,0	3,2



## Anello orientabile per L Single banjo body

Code	Ø	F	D1	E	L	L1	CH1	Gr
RA300M54NI	4	M5	5,1	9,0	9,0	18,0	10	13,0
RA300186NI	6	1/8	9,9	14,0	14,5	27,0	12	20,0
RA300146NI	6	1/4	13,3	18,0	14,5	30,0	12	26,0
RA300188NI	8	1/8	9,9	14,0	14,5	28,0	14	22,6
RA300148NI	8	1/4	13,3	18,0	14,5	31,0	14	29,8
RA3001410NI	10	1/4	13,3	18,0	14,5	32,0	17	35,0

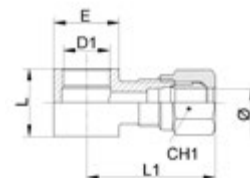

## Passaparete Bulkhead connector

Code	Ø	L	CH	CH1	Fil	Gr
RP3006NI	6	48,0	14	12	M10x1	32,0
RP3008NI	8	53,0	17	14	M12x1	45,0
RP30010NI	10	62,5	19	19	M16x1,5	64,5
RP30012NI	12	64,5	22	22	M18x1,5	84,5

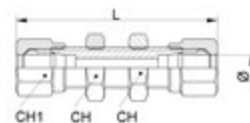

## Raccordo a croce

### Cross bulkhead connector

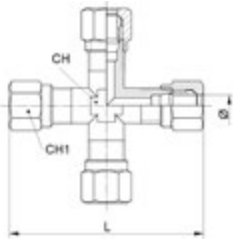

Code	Ø	L	CH	CH1	Gr
CR1006NI	6	51,0	10	12	46,0
CR1008NI	8	53,0	10	14	59,0

## Raccordo diritto maschio conico

### Straight male adapter

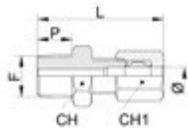

Code	Ø	F	P	L	CH	CH1	Gr
D505184GR	4	1/8	8,0	27,0	10	10	15,0
D505144GR	4	1/4	11,0	30,5	14	10	24,0
D505186GR	6	1/8	8,0	28,0	12	12	19,0
D505146GR	6	1/4	11,0	31,0	14	13	27,0
D505386GR	6	3/8	11,0	31,0	17	13	37,5
D505188GR	8	1/8	8,0	29,5	12	14	20,4
D505148GR	8	1/4	11,0	32,5	14	14	26,8
D505388GR	8	3/8	11,0	33,5	17	14	39,0
D5051410GR	10	1/4	11,0	36,0	17	19	45,3
D5053810GR	10	3/8	11,0	36,0	17	19	52,6
D5051210GR	10	1/2	14,0	40,0	22	19	79,0
D5051412GR	12	1/4	11,0	36,5	19	22	58,3
D5053812GR	12	3/8	11,0	36,5	19	22	62,0
D5051212GR	12	1/2	14,0	40,5	22	22	85,0
D5051214GR	14	1/2	14,0	40,5	22	24	90,0
D5051215GR	15	1/2	14,0	40,5	22	27	80,0

## Raccordo diritto maschio cilindrico Straight male adapter (parallel)

Code	Ø	F	P	L	CH	CH1	Gr
D5053184GR	4	1/8	6,5	26,0	14	10	15,0
D5053144GR	4	1/4	8	28	17	10	24,5
D5053186GR	6	1/8	6,5	26,5	14	13	17,0
D5053188GR	8	1/8	6,5	28,0	14	14	20,0
D5053146GR	6	1/4	8,0	28,0	17	13	24,0
D5053148GR	8	1/4	8,0	29,5	17	14	26,0

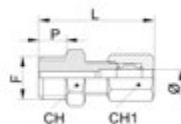

## Raccordo diritto femmina Straight female adapter

Code	Ø	F	P	L	CH	CH1	Gr
D506184GR	4	1/8	8,5	27,0	14	10	18,6
D506186GR	6	1/8	8,5	27,5	14	13	22,8
D506146GR	6	1/4	11,5	30,5	17	13	29,8
D506188GR	8	1/8	8,5	29,0	14	14	24,6
D506148GR	8	1/4	11,5	32,0	17	14	31,5
D506388GR	8	3/8	12,5	34,0	22	14	33,0
D5061410GR	10	1/4	11,5	35,0	17	19	26,7
D5063810GR	10	3/8	12,5	37,0	22	19	45,8

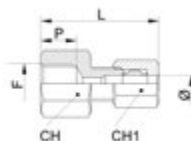

## Raccordo diritto intermedio Straight connector



Code	Ø	Ø1	L	CH	CH1	Gr
DD5254GR	4	4	35,0	10	10	18,7
DD5256GR	6	6	36,0	12	13	27,0
DD5258GR	8	8	39,0	14	14	31,0
DD52510GR	10	10	46,0	17	19	61,0
DD52512GR	12	12	47,0	19	22	99,0
DD52514GR	14	14	55,5	24	27	110,0

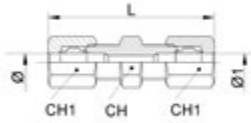

## Raccordo a L maschio conico Elbow male adapter (taper)



Code	Ø	F	P	L	L1	CH	CH1	Gr
L502184GR	4	1/8	8,5	17,0	24,0	9	10	16,2
L502144GR	4	1/4	11,0	20,0	24,0	10	10	25,6
L502186GR	6	1/8	8,5	17,0	24,5	9	13	19,8
L502146GR	6	1/4	11,0	20,0	24,5	10	13	30,2
L502188GR	8	1/8	8,5	18,0	25,5	10	14	26,8
L502148GR	8	1/4	11,0	21,0	28,5	10	14	29,2
L5021410GR	10	1/4	11,0	24,5	33,5	14	19	55,0
L5023810GR	10	3/8	12,0	26,5	33,5	14	19	61,3
L5021210GR	10	1/2	14,0	29,5	35,0	17	19	84,3
L5021412GR	12	1/4	11,0	24,5	35,0	14	22	66,5
L5023812GR	12	3/8	12,0	26,5	35,5	17	22	82,0
L5021212GR	12	1/2	14,0	29,5	35,5	17	22	92,6
L5021214GR	14	1/2	14,0	29,5	37,0	17	24	90,7
L5021215GR	15	1/2	14,0	29,5	37,0	17	24	94,8

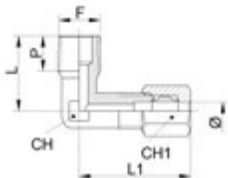

## Raccordo a L femmina

### Elbow female adapter

Code	Ø	F	P	L	L1	CH	CH1	Gr
L509184GR	4	1/8	8,5	20,5	24,0	10	10	22,6
L509186GR	6	1/8	8,5	20,5	24,5	10	13	26,0
L509146GR	6	1/4	11,0	23,5	25,5	11	13	30,0
L509188GR	8	1/8	8,5	21,5	28,0	10	14	30,0
L509148GR	8	1/4	11,0	23,5	27,0	11	14	30,0
L5091410GR	10	1/4	11,0	27,5	33,0	14	19	57,0

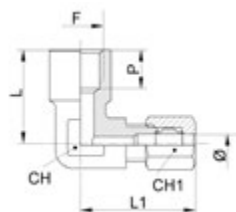

## Raccordo a L intermedio

### Elbow connector

Code	Ø	L	CH	CH1	Gr
L5224GR	4	24,0	9	10	21,4
L5226GR	6	24,5	9	13	35,5
L5228GR	8	28,0	10	14	36,5
L52210GR	10	33,5	14	19	79,6
L52212GR	12	35,0	17	22	112,0
L52214GR	14	36,5	17	24	117,5
L52215GR	15	36,5	17	24	121,6

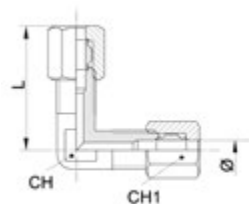

## Raccordo a T intermedio Elbow connector



Code	Ø	L	CH	CH1	Gr
TT5214GR	4	44,0	9	10	27,2
TT5216GR	6	45,0	9	13	39,8
TT5218GR	8	54,0	12	14	51,5
TT52110GR	10	63,0	13	19	111,0
TT52112GR	12	71,0	17	22	162,0
TT52115GR	15	73,0	17	24	165,0

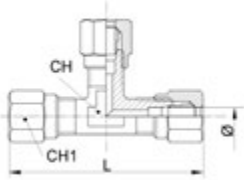

## Raccordo a T maschio centrale conico Elbow male adapter (taper)



Code	Ø	F	P	L	L1	CH	CH1	Gr
TC500184GR	4	1/8	8,5	44,0	16,0	9	10	24,6
TC500186GR	6	1/8	8,5	45,0	16,0	9	13	31,2
TC500146GR	6	1/4	11,0	50,0	20,0	10	13	40,4
TC500188GR	8	1/8	8,5	54,0	19,5	12	14	38,2
TC500148GR	8	1/4	11,0	54,0	20,5	12	14	44,2
TC500388GR	8	3/8	12,0	58,0	26,0	13	14	61,0
TC5001410GR	10	1/4	11,0	64,0	26,0	13	19	73,8
TC5003810GR	10	3/8	12,0	63,0	26,0	13	19	86,0
TC5001210GR	10	1/2	14,0	70,0	30,0	17	19	129,0
TC5001412GR	12	1/4	11,0	65,0	26,0	13	22	103,8
TC5003812GR	12	3/8	12,0	71,0	28,0	17	22	134,0
TC5001212GR	12	1/2	14,0	71,0	30,0	17	22	140,6
TC5001215GR	15	1/2	14,0	73,0	30,0	17	24	142,0

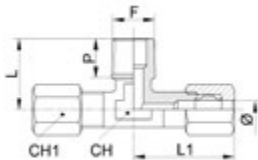



## Raccordo a T maschio laterale conico Tee male adapter - offset leg (taper)

Code	Ø	F	P	L	L1	CH	CH1	Gr
TL501184GR	4	1/8	8,5	38,0	22,0	9,0	10,0	24,6
TL501186GR	6	1/8	8,5	38,5	22,5	9,0	13,0	31,2
TL501148GR	6	1/4	11,0	45,0	25,0	10,0	13,0	40,4
TL501188GR	8	1/8	8,5	46,5	27,0	12,0	14,0	38,2
TL501148GR	8	1/4	11,0	47,5	27,0	12,0	14,0	44,2
TL501388GR	8	3/8	12,0	55,0	29,0	13,0	14,0	61,0
TL5011410GR	10	1/4	11,0	58,0	32,0	13,0	19,0	73,8
TL5013810GR	10	3/8	12,0	57,5	31,5	13,0	19,0	86,0
TL5011210GR	10	1/2	14,0	65,0	35,0	17,0	19,0	129,0
TL5011412GR	12	1/4	11,0	58,5	32,5	13,0	22,0	103,8
TL5013812GR	12	3/8	12,0	63,5	35,5	17,0	22,0	134,0
TL5011212GR	12	1/2	14,0	65,5	35,5	17,0	22,0	140,6

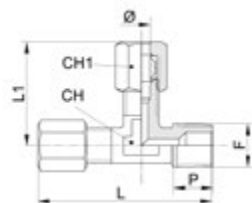

## Dado di bloccaggio Locking nut

Code	Ø	F	L	CH	Gr
G5304GR	4	M8x1	11,0	10,0	5,0
G5306GR	6	M10x1	11,5	13,0	8,0
G5308GR	8	M12x1	13,0	14,0	8,0
G53010GR	10	M16x1,5	15,0	19,0	18,5
G53012GR	12	M18x1,5	15,0	22,0	26,0
G53014GR	14	M20x1,5	15,0	24,0	29,0
G53015GR	15	M20x1,5	15,0	24,0	28,0

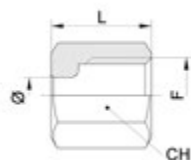

## Ogiva Ogive

Code	Ø	L	Gr
OG5314GR	4	6,0	0,7
OG5316GR	6	6,5	1,0
OG5318GR	8	7,0	1,5
OG53110GR	10	8,0	2,8
OG53112GR	12	8,5	4,0
OG53114GR	14	8,5	4,7
OG53115GR	15	8,5	3,8

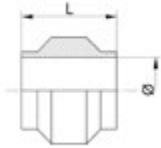

## Raccordo a L orientabile maschio cilindrico con OR L adjustable male parallel adapter with OR

Code	Ø	F	CH	CH1	CH2	P	L	L1
L510184GR	4	1/8	10	10	14	6,5	22,0	30,0
L510186GR	6	1/8	10	13	14	6,5	22,0	31,0
L510148GR	6	1/4	13	13	17	8,0	29,0	35,0
L510188GR	8	1/8	11	14	14	6,5	24,0	34,5
L510148GR	8	1/4	13	14	17	8,0	29,0	36,0
L510388GR	8	3/8	13	14	22	9,0	29,0	36,0
L5101410GR	10	1/4	13	19	17	8,0	29,0	40,0
L5103810GR	10	3/8	17	19	22	9,0	33,0	44,0
L5101210GR	10	1/2	17	19	26	10,0	35,0	44,0
L5103812GR	12	3/8	17	22	22	9,0	33,0	45,0
L5101212GR	12	1/2	17	22	26	10,0	35,0	45,0
L5101214GR	14	1/2	17	24	26	10,0	35,0	48,0
L5101215GR	15	1/2	17	24	26	10,0	35,0	48,5

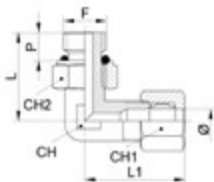

## Passaparete Bulkhead connector

Code	Ø	L	CH	CH1	Gr
RP5006GR	6	47,0	14	14	30,0
RP5008GR	8	52,0	17	17	36,0

